

650 (26")

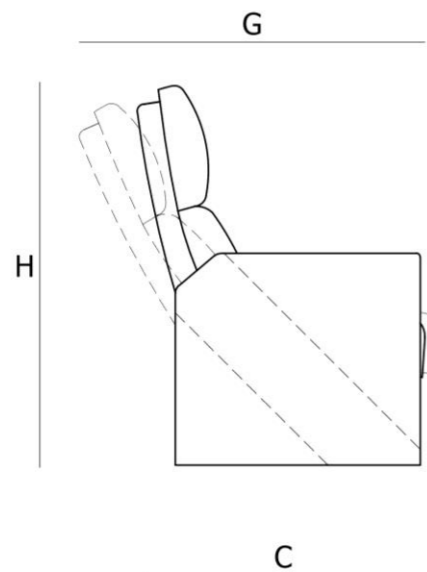

G

H

C

DIMENSIONS	
H	1070 (42.5")
C	780 (31")
G	960 (38")

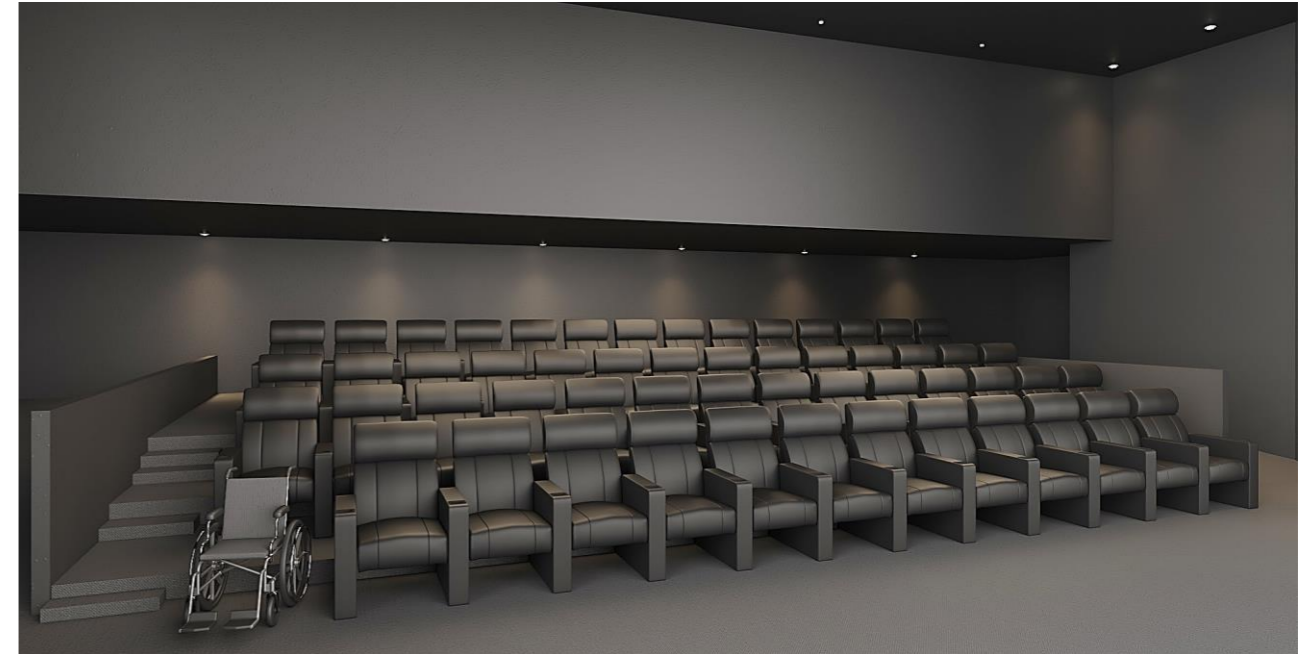

FERCO SEATING ILLUSTRATION ONLY

**Product Specifications**

**Structure**

- Made up of mild steel hollow section in various sizes like: 19mm x 19mm x Thk1.6mm, 19mm x 38mm x Thk 2.0mm, metal plate Thk5.0mm and Ø19 x Thk 2.0mm.
- High durability non motorised gliding mechanism.

**Backrest and Seat**

- Glided backrest (with headrest) with inner structure made of Ø19mm x Thk 2.0mm metal frame covered with high resilience foam, upholstered in leatherette / leather / fabric and topped with backrest and headrest paddings made from high resilience foam, upholstered in leatherette / leather / fabric.
- Glide seat unit with inner structure made of Ø19mm x Thk 2.0mm metal frame fully covered with high resilience foam and upholstered in leatherette / leather / fabric and topped with seat padding made from high resilience foam, upholstered in leatherette / leather / fabric.

**Panel**

- Combination of wooden ply and solid wood, and a mild steel frame, covered with high resilience foam, upholstered in leatherette / leather / fabric and a built-in cup holder.

**Metal and Upholstery Finishing**

- All metal parts exposed shall be stripped and cleaned with iron phosphate, hot water rinsed and then chromic acid rinsed.
- All metal parts are coated with an epoxy finish minimum of 60 microns for outdoor use.
- Refer Ferco standard fabrics / leatherette / leather charts.

**Fire Resistance**

- Fire Safety - Flammability compliance with California Bulletin 117 and international regulations in their last issues and particularly with safety regulations.
- Flammability compliance with BS 5852 : 2006 Section 3 Ignition Source 0 & 1.

**Warranty**

- Refer to Ferco Product Warranty.

**Options**

- Single seat / Linked seat
- Row lettering type E with Aisle light
- Row lettering type A
- Puck light row lettering
- Square light row lettering (80 x 80mm)
- Embroidery logo
- Embroidery seat numbering
- Dual USB Charging Port
- Gooseneck light
- Swivel table A&B / Smart swivel table / Double action swivel table
- Rectangular table top
- Flammability compliance with BS 5852 : 2006 Section 3 Ignition Source 5